



# SOUDAL WINDOW SYSTEM

THE PROFESSIONAL WINDOW JOINT SEALING SYSTEM



**SOUDAL**



India



Poland



Italy



Soudal, world leader in silicones, PU foam, adhesives

## Family business



Founded by Vic Swerts in 1966



100% family owned



Long-term growth strategy

## Market segments

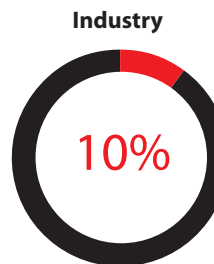
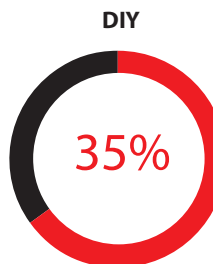
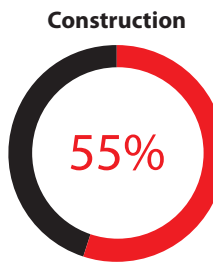

## Internationalisation



69

Own affiliates



+3.200

People



140

Countries

and technical sprays, is a renowned Belgian family business.

## Facts & figures

# TURNOVER

2019

€ 893 mio



260.000.000 cartridges

105.000.000 cans

20 production sites

12.000 SKU's

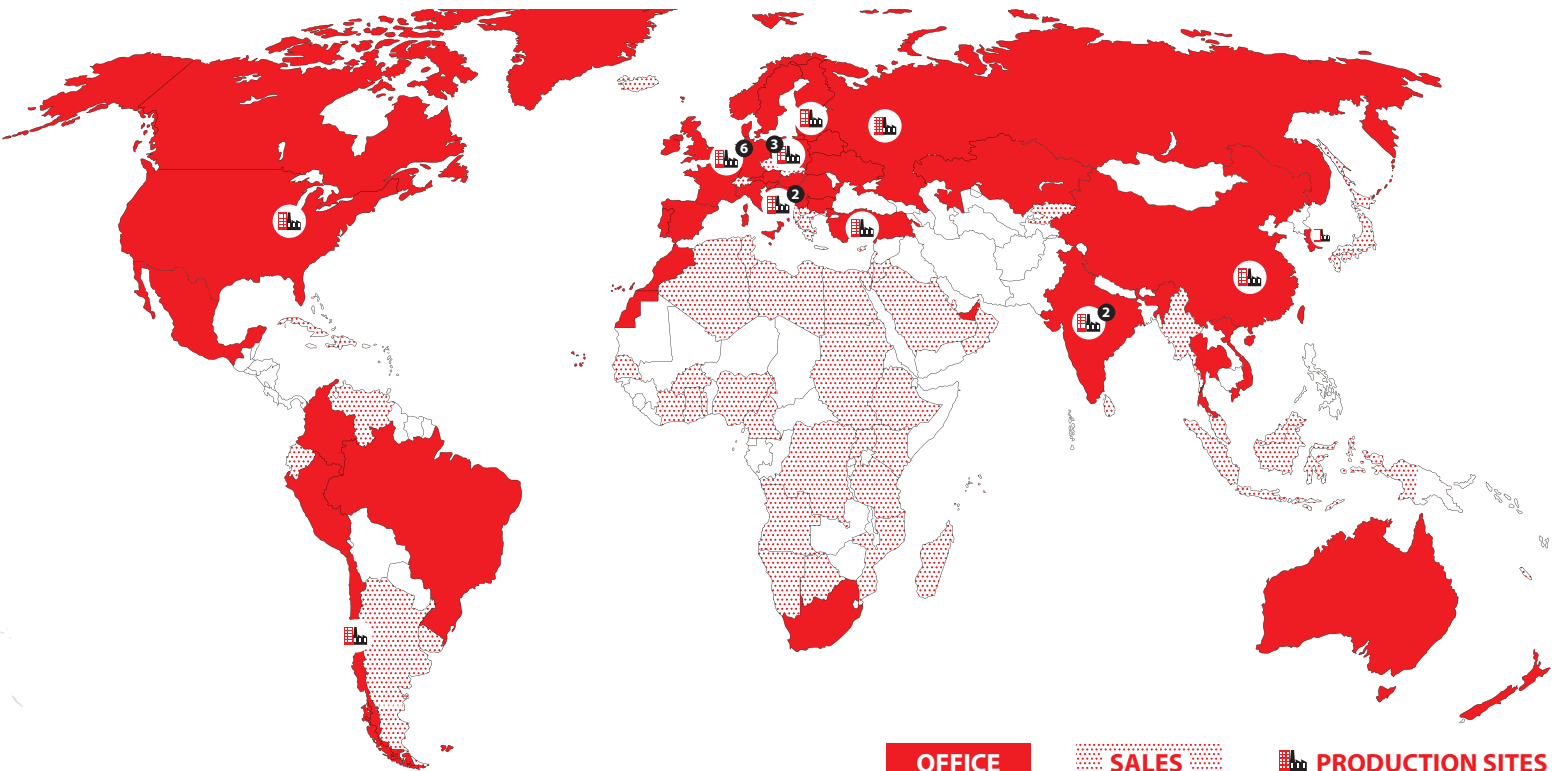

# LEGISLATION



The energy performance of buildings is based on European legislation, in particular the original directive 2002/91/EC, also called the EPBD. This directive was in line with the “20-20-20 targets” of the European Union: to reduce CO<sub>2</sub> gas emissions by 20%, to reduce energy consumption by 20% and to increase the share of renewable energy to 20% (reference year: 1990). Other considerations played a role as well, such as a reduced dependency on non-European energy sources. The subject of renewable energy is further detailed in European Directive 2009/28/EC; a minimum renewable energy share will also be slowly introduced into the energy performance requirements for new buildings.

Because the current path could not ensure a 20% reduction in energy consumption by 2020, Europe created the 2012/27/EC Directive. This directive covers the general subject “energy efficiency” and came into effect in December 2012. It mainly affects existing houses and buildings. Belgium, for example, has set targets for each of its 3 regions, which should result in an annual energy saving of 1,5% for the period 2014-2020. Energy policy agreements for companies are an example of this, just like the better known premium systems through distribution network operators, mostly effecting the existing building stock.

## NZEB

The recast of the energy performance directive (2010/31/EC) included not only stricter requirements for new buildings and renovations, and a stronger role for the energy performance certificate, but also the introduction of the term NZEB (Nearly Zero Energy Building). The description in the recast was:

*“A building with a very high energy performance, as set out in Appendix I. The nearly zero or very low amount of energy required should be covered to a very significant extent by energy from renewable sources, including energy from renewable sources produced on-site or nearby.”*

**As from 2021, this will be the standard for all newly built houses in the whole of Europe!**

In the run-up to 2021, the energy performance requirement for new buildings will gradually become more strict. The final objective is the transfer to NZEB at the beginning of 2021 and for public buildings this will already apply as from 2019. Simultaneously, an increasingly large mandatory share of renewable energy will have to be realised. As this European legislation has been set out in a Directive, the member states will have to convert this European policy into national legislation and integrate it into local energy policies. NZEB buildings are set to be the standard for all new homes across the whole of Europe from 2021!

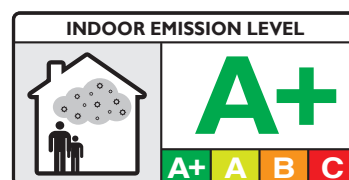

# PASSIVE HOUSE

The passive house concept is based on the ideas developed by Dr. Feist at the University of Darmstadt (Germany) in the 1990s.

## It was founded on the Trias Energetica:

- Prevention: limit energy consumption by avoiding waste
- Use sustainable sources of energy as much as possible
- Use fossil fuels as efficiently as possible to meet the remaining energy needs

For translating this principle into building practice, it is of prime importance to take great care ensuring the building envelope is very well insulated and airtight.

Attention should also be paid to compactness, good orientation and, of course, controlled ventilation. In the original concept the ventilation ducts were also used for heating purposes; due to the absence of a classic 'active' heating system this type of house was called a passive house.

## Meanwhile other "heating aids" are being used but the basic criteria for a passive house have remained the same:

- Net energy need for heating  $\leq 15 \text{ kWh/m}^2$  per year
- Airtightness n50-value  $\leq 0,6 \text{ vol/h}$
- Temperature exceedance factor above  $25^\circ\text{C} \leq 5\%$

This translates into a building which has, in winter as well as summer, a very comfortable interior climate and requires only a minimum amount of heating. It is obvious that a passive house is the ideal way to achieve an NZEB as the limited energy needed can easily be met by renewable energy. Meaning: Zero Energy Ready! For this reason, in 2015, the Brussels District (Belgium) opted for the passive house standard for all newly built houses in the run-up to 2021. Brussels obviously wants to play a pioneer-ing role as the European capital!

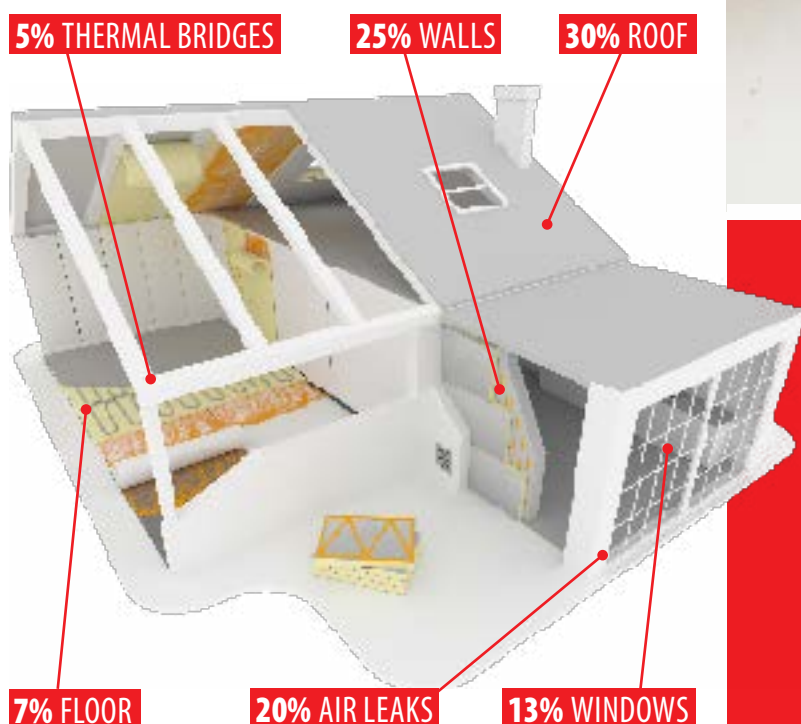

# AIRTIGHTNESS

## Airtightness

It will be clear that it has gradually become very difficult to meet the requirements without paying attention to airtightness. Uncontrolled ventilation losses cause heat loss, draft, poor acoustics and damp or moisture problems. Good airtightness and a high quality building envelope go hand in hand. Furthermore, good airtightness is one of the most economical ways to improve the energy performance of a building.

"A limited investment with a big impact on the E-value: attention to airtightness when building a house (e.g. a leak flow of 2 to 3 m<sup>3</sup> per hour per m<sup>2</sup>) may result in a reduction of the E-value by 5 to 15 E-value points. This is measured by way of an airtightness test. If a house is not tested, it is assumed that it has a lesser airtightness of 12 m<sup>3</sup> per hour per m<sup>2</sup>. The net energy requirement will also substantially decrease."

This airtightness test is also regulated and its working method is set out in the European standard EN13829 (method A or B). For example, in Flanders method A must be followed. The leak flow is measured at underpressure and overpressure; the result of the measurement is leak flow at a pressure difference of 50 Pa between the inside and outside. In some countries the value for the report is recalculated at 4 Pa (France) or 10 Pa (the Netherlands). In order to achieve accurate measurements, many countries have implemented a quality framework for testers.

Window-to-wall joints are of crucial importance; poor execution accounts for an estimated 15% of the total air loss in an average detached house. The Soudal Window System (SWS) is therefore an important contribution to good airtightness.

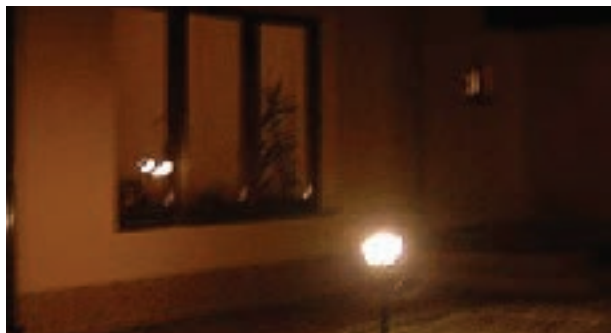

# SOUDAL WINDOW SYSTEM

## Soudal Window System

Soudal has already been known for years as a reputable manufacturer of high quality products for sealing and insulation in the construction world. Many of these products are separately certified and are already successfully used for the installation of windows and doors. Together with installers, building promoters and architects. Soudal has combined all its know-how related to window joints in the Soudal Window System, a professional window joint sealing system. SWS intelligently combines highly developed versions of a number of known products for sealing between joinery and brickwork.

### The optimal sealing of window joints is done at 3 levels:

Good airtightness on the inside, thermal and acoustic insulation in the middle, and excellent protection against all sorts of weather influences (wind, UV and driving rain) on the outside. This is done in conformity with EnEV, DIN 4108-7 and the directives for a RAL assembly.

With its many certified products and as a result of their guaranteed constant high quality, the strength of the Soudal Window System lies in its diversity. The product range consists of different products (sealants, PU foams, pre-compressed tapes, membranes, self-adhesive tapes and liquid membranes), which can be perfectly combined with one other. There is always a perfectly suited SWS solution, regardless of the building or installation method, both for newly built houses as for renovations and even for «passive houses». The system is obviously also suitable for all types of joinery: aluminium, wood and PVC.

[www.soudalairtight.com](http://www.soudalairtight.com)



# SOUDAL WINDOW SYSTEM

## The best window badly installed is a bad window!

All building details are important under the EPB directive, so window joints too. What use are ultra-insulating walls, window frames and glazing in a building if thermal bridges or air leaks between them mean heat and energy are lost?

### THE SEALING OF WINDOW JOINTS IS REALISED ON 3 LEVELS

**OUT**  
OUTSIDE

**MID**  
MIDDLE

**IN**  
INSIDE

#### Weather protection:

- **Driving rain tight:**  
keeps water from outside from penetrating the building envelope
- **Vapour permeable:**  
promotes water vapour to evacuate to the outside
- **Air- and wind tight:**  
prevents the movement of air due to atmospheric pressure from outside (wind)

#### Insulation:

- **Acoustic:**  
avoids noise, vibrations of building elements from travelling through the building envelope
- **Thermal:**  
limits thermal exchanges between the outside and the inside and minimizes the energy consumption needed to maintain the required temperature

#### Moisture protection:

- **Airtight:**  
prevents the movement of air due to atmospheric pressure from inside
- **Vapour retardant:**  
keeps internal moisture from infiltrating the connection joint

SWS products	Levels	Thickness (mm)	$\mu$ value	Sd value (m)
SWS Vario Extra	<b>OUTSIDE:</b> WEATHER PROTECTION	0,38	80 - 40000	0,03 - 15
SWS Outside Standard		0,66	$\leq 97$	$\leq 0,06$
SWS Outside Extra		0,66	$\leq 1092$	$\leq 0,72$
Soudaband PRO BG1 (width 50 mm)		Compression : see page 23	$\leq 100$	$\leq 0,50$
Silirub PRO N		4	577	2,08
Silirub 2 / Silirub Color		4	-	-
Soudaseal 215LM		4	991	3,96
Soudaseal 225		4	-	-
Soudatight Hybrid		1	1464	1,4
Flexifoam		<b>MIDDLE:</b> INSULATION	19	20
Soudaband Aktiv Plus (width 50 mm) <small>*Soudaband Aktiv Plus alone ensures the sealing on all 3 levels</small>	Compression : see page 23		$\leq 100$	$\leq 0,50$
Acryrub SWS	<b>INSIDE:</b> AIRTIGHTNESS	4	7186	21,6
SWS Inside Standard		0,87	$\geq 69027$	$\geq 47$
SWS Inside Extra		0,69	$\geq 54883$	$\geq 47$
SWS Vario Extra		0,38	80 - 40000	0,03 - 15
Soudatight LQ		1	10241	10,96
Soudatight SP (Gun)		1	$> 20000$	$> 20$



# SOUDAL WINDOW SYSTEM

## The SWS model



Soudal has developed a professional 3-level window joint connection system between the building structure and the window frame in accordance with current legislations.



**SWS**

**Soudal offers a window sealing system (SWS) active on 3 levels:**

- **Weather protection**
- **Thermal and acoustic insulation**
- **Air- and vapour tightness**

		OUTSIDE	MIDDLE	INSIDE
		<b>OUT</b>	<b>MID</b>	<b>IN</b>
				
<b>Choose for each level your preferred product:</b>		<b>Function :</b>	<b>Function :</b>	<b>Function :</b>
<b>PU foam</b>		<ul style="list-style-type: none"> <li>Driving rain tight</li> <li>Air- and wind tight</li> <li>Vapour permeable</li> </ul>	<ul style="list-style-type: none"> <li>Acoustic insulation</li> <li>Thermal insulation</li> </ul>	<ul style="list-style-type: none"> <li>Airtightness</li> <li>Vapour retardant</li> </ul>
<b>Liquid membranes</b>		Soudatight Hybrid	Flexifoam	Soudatight LQ Soudatight SP Soudatight SP GUN
<b>Membranes</b>		SWS Outside Standard SWS Outside Extra SWS Vario Extra		SWS Inside Standard SWS Inside Extra SWS Vario Extra
<b>Pre-compressed tapes</b>		Soudaband PRO BG1	Soudaband PRO BG1	Soudaband PRO BG1
		Soudaband Aktiv Plus		
<b>Sealants</b>	Hybrid	Soudaseal 215 LM Soudaseal 225		
	Acrylic			Acryrub SWS
	Silicone	Silirub PRO N Silirub 2 Silirub Color		

# TUNNEL INSTALLATION

## BASIC

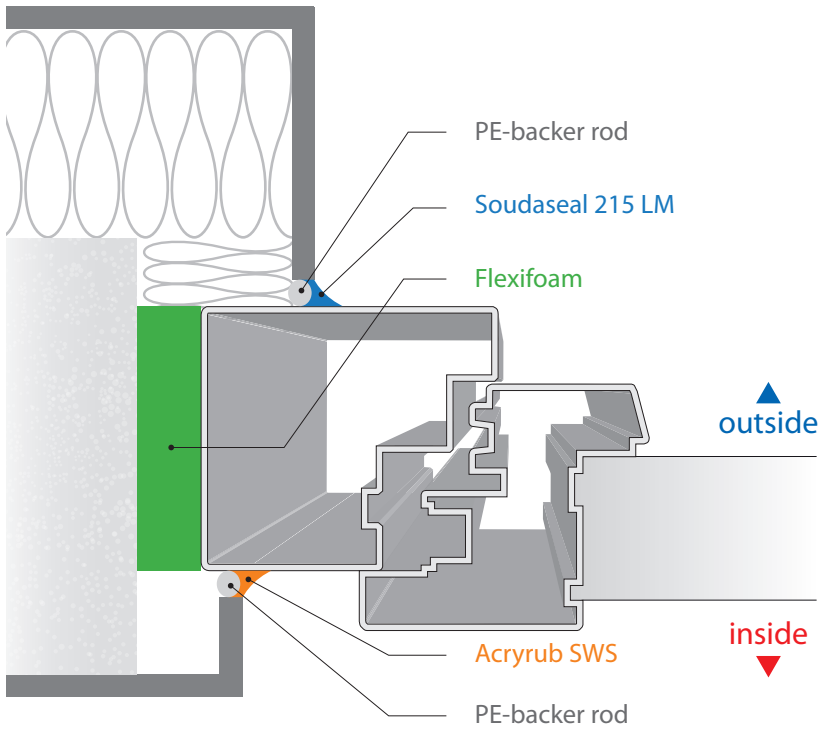

## PLUS

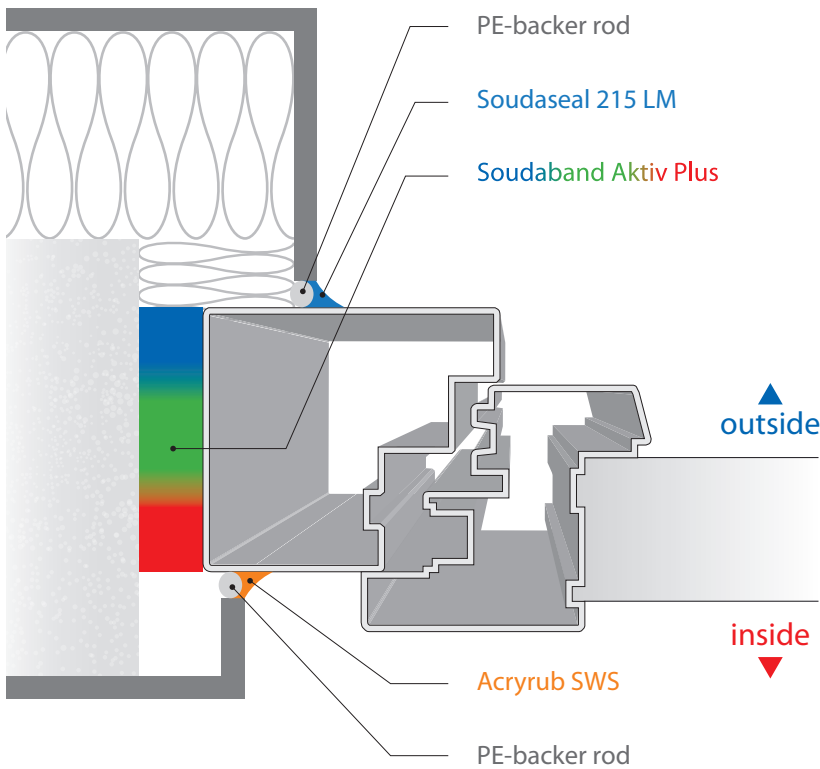

# TUNNEL INSTALLATION

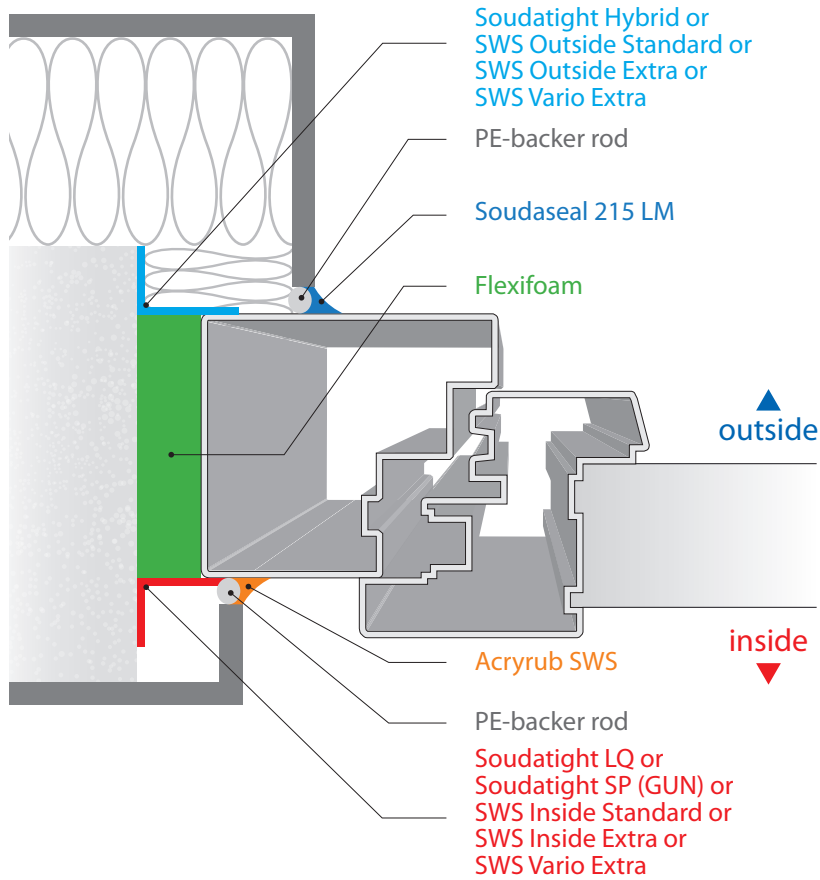

## PREMIUM



## PREMIUM



## Product overview

	OUTSIDE	MIDDLE	INSIDE
<b>BASIC</b> 	<ul style="list-style-type: none"> <li>Soudaseal 215LM or Soudaseal 225 or Silirub PRO N or Silirub 2 or Silirub Color</li> </ul>	<ul style="list-style-type: none"> <li>Flexifoam</li> </ul>	<ul style="list-style-type: none"> <li>Acryrub SWS</li> </ul>
<b>PLUS</b> 	<ul style="list-style-type: none"> <li>Soudaseal 215LM or Soudaseal 225 or Silirub PRO N or Silirub 2 or Silirub Color</li> </ul>	<ul style="list-style-type: none"> <li>Soudasband Aktiv Plus</li> </ul>	<ul style="list-style-type: none"> <li>Acryrub SWS</li> </ul>
<b>PREMIUM</b> 	<ul style="list-style-type: none"> <li>Soudaseal 215 LM or Soudaseal 225 or Silirub PRO N or Silirub 2 or Silirub Color</li> <li>Soudatight Hybrid or SWS Outside Standard or SWS Outside Extra or SWS Vario Extra</li> </ul>	<ul style="list-style-type: none"> <li>Flexifoam</li> </ul>	<ul style="list-style-type: none"> <li>Acryrub SWS</li> <li>Soudatight LQ or Soudatight SP (GUN) or SWS Inside Standard or SWS Inside Extra or SWS Vario Extra</li> </ul>

# CAVITY WALL INSTALLATION

## BASIC

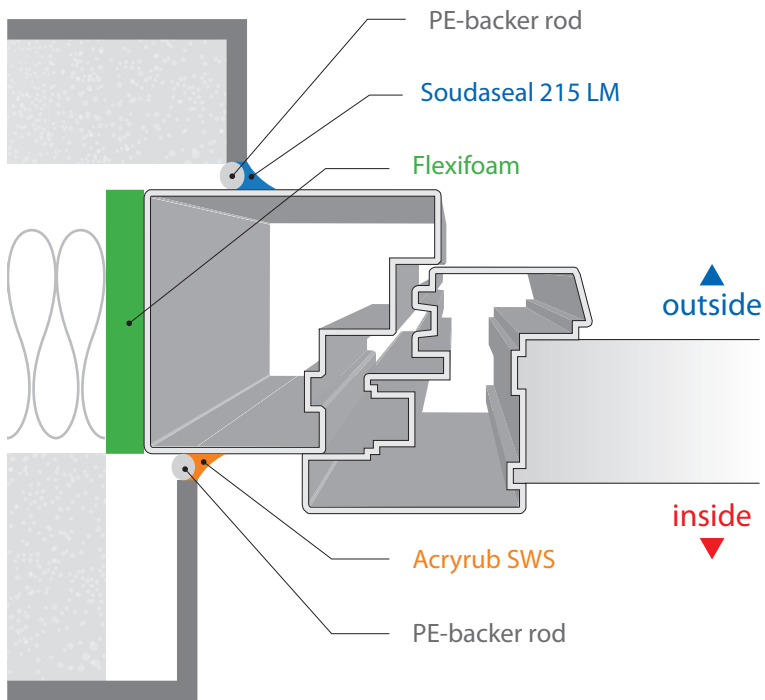

## PLUS

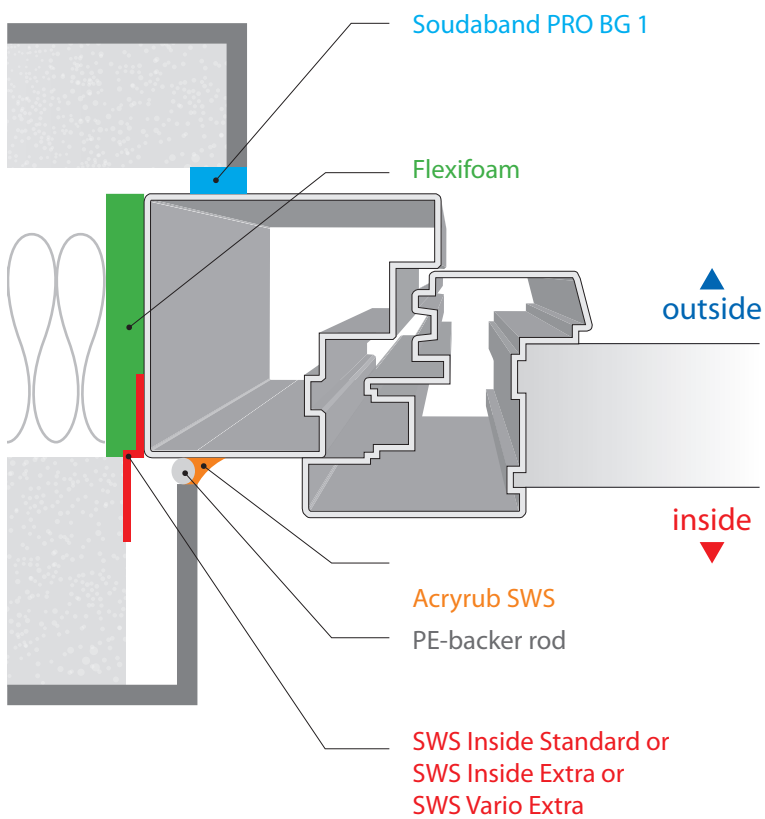

# CAVITY WALL INSTALLATION

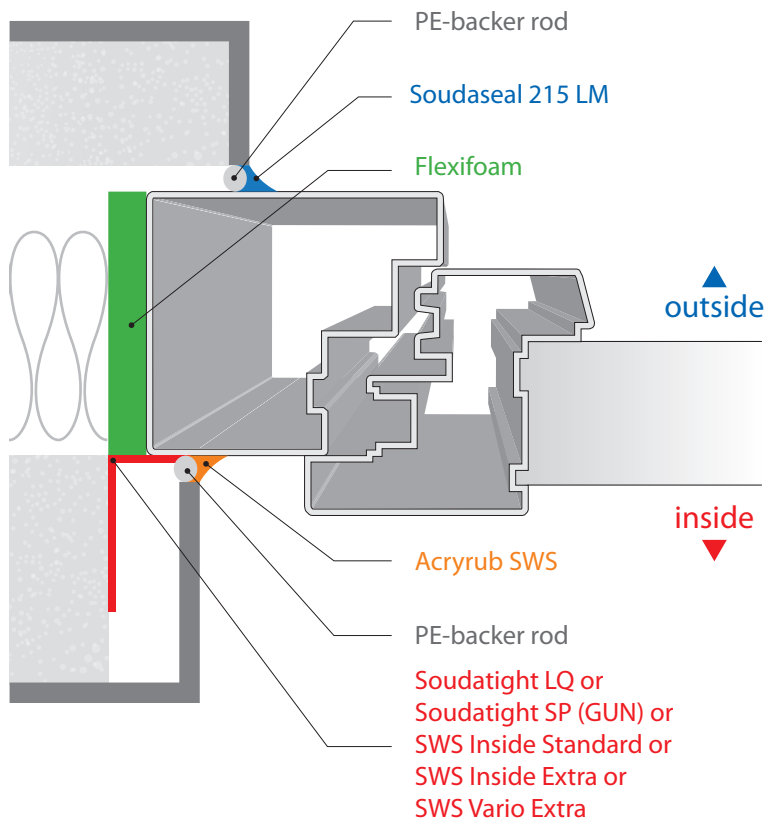

## PREMIUM



## PREMIUM



## Product overview

	OUTSIDE	CENTRE	INSIDE
<b>BASIC</b> 	<ul style="list-style-type: none"> <li>Soudaseal 215LM or Soudaseal 225 or Silirub PRO N or Silirub 2 or Silirub Color</li> </ul>	<ul style="list-style-type: none"> <li>Flexifoam</li> </ul>	<ul style="list-style-type: none"> <li>Acryrub SWS</li> </ul>
<b>PLUS</b> 	<ul style="list-style-type: none"> <li>Soudaseal 215 LM or Soudaseal 225 or Silirub PRO N or Silirub 2 or Silirub Color</li> <li>Soudaband PRO BG 1</li> </ul>	<ul style="list-style-type: none"> <li>Flexifoam</li> </ul>	<ul style="list-style-type: none"> <li>Acryrub SWS</li> </ul>
<b>PREMIUM</b> 	<ul style="list-style-type: none"> <li>Soudaseal 215LM or Soudaseal 225 or Silirub PRO N or Silirub 2 or Silirub Color</li> </ul>	<ul style="list-style-type: none"> <li>Flexifoam</li> </ul>	<ul style="list-style-type: none"> <li>Acryrub SWS</li> <li>Soudatight LQ or Soudatight SP (GUN) or SWS Inside Standard or SWS Inside Extra or SWS Vario Extra</li> </ul>



# SEALI OF WINDO JOINTS

**SEALING OF WINDOW JOINTS**  
**SIMPLE & EASY**

**NG**  
**W**

# PU FOAM

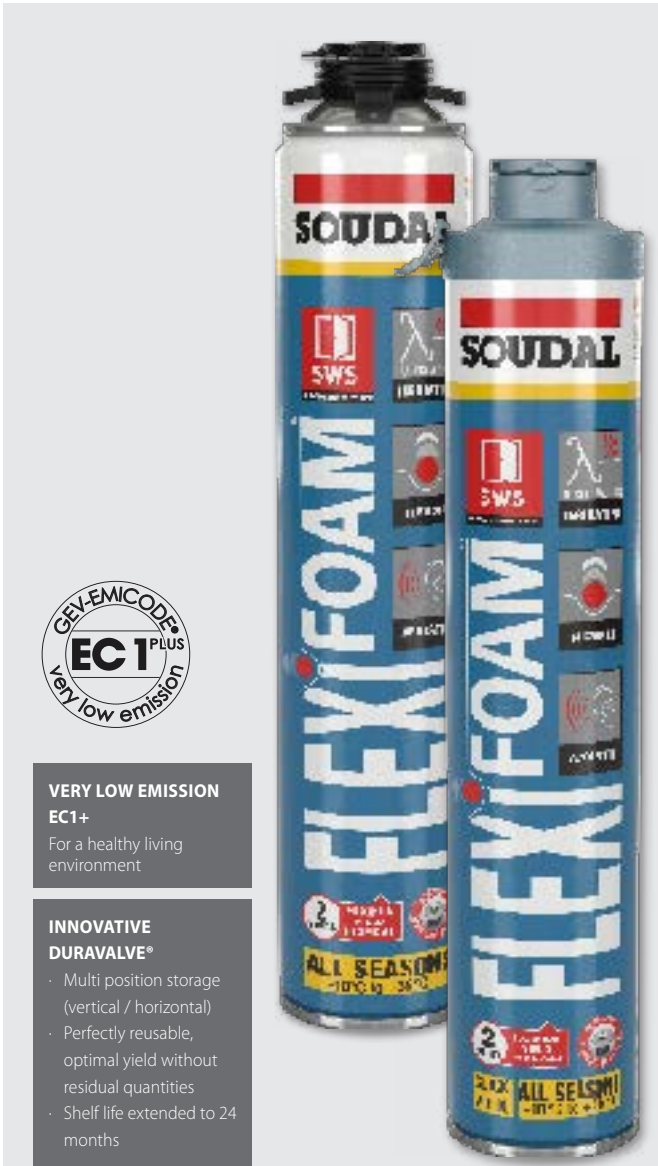

**VERY LOW EMISSION**  
**EC1+**  
 For a healthy living environment

**INNOVATIVE DURAVALVE®**

- Multi position storage (vertical / horizontal)
- Perfectly reusable, optimal yield without residual quantities
- Shelf life extended to 24 months

## ACOUSTIC INSULATION IN DB

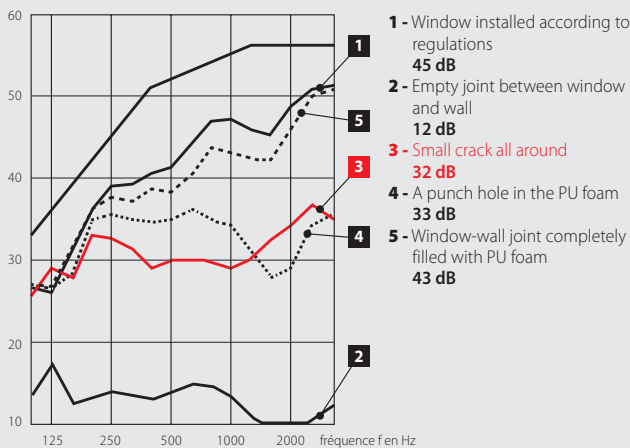

Source: Installation guide, RAL-Gütegemeinschaft Fenster und Haustüren, Ffm.

## Flexifoam

Top-grade gun applied elastic PU foam with outstanding insulation characteristics combined with ease of use. Absorbs up to 50% of joint movement and guarantees durable thermal and acoustic insulation.

Specially developed for window installation in accordance with the EPB rules by avoiding thermal bridges. Very precise application, low post expansion, very economic in use. Fast skin formation and curing, which results in shorter waiting times. Can also be used in winter at below 0°C temperatures. Recognisable blue colour. Available in screw thread and Click&Fix®. Very low VOC emissions (EC1R Plus).

### PROPERTIES:

- Elastic: 3 times more flexible than standard PU foam
- Acoustic insulation: 63 dB
- Thermal insulation:  $\lambda$  0,0345
- Airtightness:  $a < 0,1 \text{ m}^3 / (\text{h.m (daPa)}^{2/3})$
- Water vapour permeable
- Excellent stability (no shrinkage or post expansion)
- Innovative Duravalue for optimum yield

MID



## Technical specifications

### Thermal insulation

DIN 52612-1  
 $\lambda = 0,0345 \text{ W}/(\text{m.K})$  MPA Hannover

### Acoustic insulation

EN ISO 717-1  
 RST,w = 63 dB (-1;-5) (joint 10mm)  
 RST,w = 62 dB (-1;-4) (joint 20mm) ift-Rosenheim

### Water vapour permeable

DIN EN ISO 12572  
 $\mu = 20$  (respirant légèrement) ift-Rosenheim

### Airtightness

DIN 18542, Part 7.2  
 $a < 0,1 \text{ m}^3 / (\text{h.m (daPa)}^{2/3})$  ift-Rosenheim

### Elasticity

9000 cycles ift-Rosenheim  
 FEICA TM 1013 1 x 1000 cycles







# LIQUID MEMBRANES

No more fuss with window anchors and carefully folding window tapes. The Soudatight liquid membranes form a completely jointless and elastic membrane that perfectly follows the shape of the surface which guarantees excellent airtightness. For both internal and external use.



## SOUDATIGHT LQ

Brushable fibre-reinforced air- and vapour tight liquid membrane

### DESCRIPTION:

Soudatight LQ is a high quality, fibre-reinforced polymer that forms a seamless air- and vapour tight elastic membrane after drying. Use Soudatight LQ for the airtight and vapour tight finishing of penetrations and window, floor-wall, wall-ceiling and roof joints. The product can be very simply applied with a flat brush.

### PROPERTIES:

- Air- and vapour tight
- Glass fibre-reinforced (suited for crack bridging up to 2 mm)
- Stays elastic after curing
- Can be painted, plastered or taped after drying
- For inside use only
- Available in blue (turns black after curing) and white

IN



## SOUDATIGHT SP GUN

Sprayable air- and vapour tight liquid membrane

### DESCRIPTION:

Soudatight SP GUN - the sprayable version - forms a seamless air- and vapour tight elastic membrane on the joints between the window and the wall. Soudatight SP GUN is applied using the Soudatight GUN in combination with a compressor. Because the product is liquid when applied, it perfectly takes the shape of the substrate, without trapping air. Even on slightly wet or dusty surfaces.

### PROPERTIES:

- Air- and vapour tight
- Fast and easy application
- Stays elastic after curing
- Can be painted, plastered or taped after drying
- For inside use only
- Available in blue (turns black after curing)

IN



## SOUDATIGHT SP

Professional sprayable (airless) air- and vapour tight liquid membrane

### DESCRIPTION:

Soudatight SP - the airless sprayable version - forms a seamless air- and vapour tight elastic membrane on larger surfaces and in floor-wall, wall-ceiling, ... joints. Soudatight SP is applied using professional airless spraying tools.

### PROPERTIES:

- Air- and vapour tight
- Fast and easy application
- Stays elastic after curing
- Can be painted, plastered or taped after drying
- For inside use only
- Available in blue (turns black after curing) and white

IN



# LIQUID MEMBRANES

The combination of the Soudatight liquid membranes successfully passed the ift Rosenheim MO-01/1 system test. Soudal is the only manufacturer able to offer a complete window sealing solution (airtightness and protection against driving rain) based on liquid membranes.



## SOUDATIGHT HYBRID

Brushable and sprayable air- and driving rain tight liquid membrane



### DESCRIPTION:

Soudatight Hybrid - the hybrid version - is designed for both internal and external use. This product allows the very simple and quick application of a seamless air- and driving rain tight elastic membrane on penetrations, joints and surfaces (no roof applications). Soudatight Hybrid can be applied in beads or as a coating with the Jetflow 3 Foil Bag spray gun.

### PROPERTIES:

- Air- and driving rain tight
- Vapour permeable
- Stays elastic after curing
- Can be painted, plastered or taped after drying
- For outdoor use (indoor use also possible)

**IN** **OUT**



# LIQUID MEMBRANES



## SOUDATEXTILE

Non-woven fleece for use in combination with Soudatight liquid membranes

### DESCRIPTION:

Soudatight Geotextile is a non-woven fleece made from polypropylene, needle punched and heat-treated, produced without adhesive or chemical binder for use in combination with Soudatight liquid membranes for larger seam, gap and crack bridging applications. 150 mm x 20 m roll.

### PROPERTIES:

- Easy to apply
- Density: 110 g/m<sup>2</sup>
- Thickness: 0,80 mm
- Flexible
- Up to 30 days weatherproof

**IN** **OUT**



## SOUDATIGHT GUN

Pneumatic gun for Soudatight SP GUN

### DESCRIPTION:

Pneumatic gun specially developed for spraying Soudatight SP GUN. 2 spray tips included.

### ACCESSORIES:

131296: 5 spray nozzles for Soudatight GUN

### PROPERTIES:

- Heavy aluminium alloy pneumatic gun
- Suction feed
- Air pressure: 3 – 5 bar
- Special developed spray nozzle
- Switch between a horizontal to a vertical application by turning the spray nozzle
- Spray pattern: 5 cm width
- Easy to clean



## COX JETFLOW 3 FOIL BAG

Pneumatic gun for Soudatight Hybrid

### DESCRIPTION:

Multifunctional pneumatic gun for spraying Soudatight Hybrid. Switch from a bead to spraying pattern by a simple twist.

### ACCESSORIES:

131896: 10 sets of nozzles for Cox Jetflow 3 Foil Bag

### PROPERTIES:

- Lightweight and ergonomically designed pneumatic gun
- Easy adjustment between bead and spray application with one twist
- Variable speed regulator for precise control and smooth material flow
- Special nozzle set included for a wide range of bead and spray patterns
- Built-in silencer
- Air pressure: 5 bar (max 6,8 bar)

# PRE-COMPRESSED FOAM TAPES

Thanks to their versatility expansion tapes have already been widespread in the construction sector for years. From window joints to dilation joints in concrete façade elements. Soudal offers a complete range of expansion tapes with different dimensions and qualities, both standardised and non-standardised. The latest generation of multifunctional expansion tapes offers sealing on multiple levels in just one single product.



## SODABAND AKTIV PLUS

Multifunctional pre-compressed joint sealing foam tape



### DESCRIPTION:

Soudaband Aktiv Plus is a multifunctional pre-compressed foam tape for easy sealing of external joinery with a single product. Suitable for so-called tunnel installation such as in solid walls or timber constructions. Performs 3 functions: driving rain tightness to 600 Pa on the outside, thermal and acoustic insulation in the middle and airtightness on the inside of the joint.

**IN** **MID** **OUT**

### PROPERTIES:

- Combines 3 products into 1
- Driving rain tight up to 600 Pa
- Vapour permeable
- Air- and wind tight
- High performing thermal and acoustic insulation
- UV resistant and weatherproof



## SODABAND PRO BG 1

BG1 certified pre-compressed joint sealing foam tape for high-rise buildings



### DESCRIPTION:

Standardised, pre-compressed foam tape for sealing façade joints. Meets the strict requirements of DIN 18542:2009 BG1. Resistant against driving rain up to at least 600 Pa and suitable for uncovered joints (UV resistant). Ideal for sealing connections in high- and low-rise buildings, in between the window and the window sill or as a high-quality backer rod in check reveal installations. Product has ATG approval (production control) and Socotec specification text.

**OUT**

### PROPERTIES:

- Driving rain tight up to 600 Pa
- Wind- and watertight (depending on the compression ratio)
- Vapour permeable
- UV resistant and weatherproof
- Adapts to fill unevenness and joint movements
- Also available in grey



## SODABAND ACRYL 300

Pre-compressed joint sealing foam tape



### DESCRIPTION:

Soudaband Acryl 300 is a non-standardised impregnated, pre-compressed foam strip for sealing joints and connections on the inside or as a backfilling for exterior use. Ideal for fitting external joinery behind cladding if further sealed with e.g. Soudaseal 215 LM.

**IN** **OUT**

### PROPERTIES:

- Acoustic and thermally insulating
- Dustproof
- Windproof
- Vapour permeable
- Stays elastic
- Compatible with all sealants

# TAPES

Art. nr.	Description	Colour	Min. joint width	Max. joint width	Tape width = joint depth	Variant	Meter/roll	Rolls/box	Meter/box
123045	SODABAND Aktiv+ 54/5-10 5 x 5,6m	grey/red	5 mm	10 mm	54 mm	54/5-10	5,6	5	28
123042	SODABAND Aktiv+ 54/7-15 5 x 4,3m	grey/red	7 mm	15 mm	54 mm	54/7-15	4,3	5	21,5
123039	SODABAND Aktiv+ 54/10-20/5 x 3,3m	grey/red	10 mm	20 mm	54 mm	54/10-20	3,3	5	16,5
123044	SODABAND Aktiv+ 64/5-10 4 x 5,6m	grey/red	5 mm	10 mm	64 mm	64/5-10	5,6	4	22,4
123041	SODABAND Aktiv+ 64/7-15 4 x 4,3m	grey/red	7 mm	15 mm	64 mm	64/7-15	4,3	4	17,2
123034	SODABAND Aktiv+ 64/10-20 4 x 3,3m	grey/red	10 mm	20 mm	64 mm	64/10-20	3,3	4	13,2
123036	SODABAND Aktiv+ 74/5-10 4 x 5,6m	grey/red	5 mm	10 mm	74 mm	74/5-10	5,6	4	22,4
123040	SODABAND Aktiv+ 74/7-15 4 x 4,3m	grey/red	7 mm	15 mm	74 mm	74/7-15	4,3	4	17,2
123038	SODABAND Aktiv+ 74/10-20 4 x 3,3m	grey/red	10 mm	20 mm	74 mm	74/10-20	3,3	4	13,2
123043	SODABAND Aktiv+ 84/5-10 3 x 5,6m	grey/red	5 mm	10 mm	84 mm	84/5-10	5,6	3	16,8
123035	SODABAND Aktiv+ 84/7-15 3 x 4,3m	grey/red	7 mm	15 mm	84 mm	84/7-15	4,3	3	12,9
123037	SODABAND Aktiv+ 84/10-20 3 x 3,3m	grey/red	10 mm	20 mm	84 mm	84/10-20	3,3	3	9,9

Art. nr.	Description	Colour	Min. joint width	Max. joint width	Tape width = joint depth	Variant	Meter/roll	Rolls/box	Meter/box
110265	SODABAND PRO BG1 10/1-2	anthracite	1 mm	2 mm	10 mm	10/1-2	20	30	600
126630	SODABAND PRO BG1 10/1-4	anthracite	1 mm	4 mm	10 mm	10/1-4	13	30	390
121842	SODABAND PRO BG1 12/2-6	anthracite	2 mm	6 mm	12 mm	12/2-6	12	25	300
126662	SODABAND PRO BG1 15/1-2	anthracite	1 mm	2 mm	15 mm	15/1-2	20	20	400
110267	SODABAND PRO BG1 15/1-4	anthracite	1 mm	4 mm	15 mm	15/1-4	13	20	260
110268	SODABAND PRO BG1 15/2-6	anthracite	2 mm	6 mm	15 mm	15/2-6	12	20	240
121840	SODABAND PRO BG1 15/4-9	anthracite	4 mm	9 mm	15 mm	15/4-9	8	20	160
122844	SODABAND PRO BG1 15/5-12	anthracite	5 mm	12 mm	15 mm	15/5-12	5,6	20	112
122339	SODABAND PRO BG1 15/6-15	anthracite	6 mm	15 mm	15 mm	15/6-15	4,3	20	86
126658	SODABAND PRO BG1 20/1-4	anthracite	1 mm	4 mm	20 mm	20/1-4	13	15	195
121841	SODABAND PRO BG1 20/2-6	anthracite	2 mm	6 mm	20 mm	20/2-6	12	15	180
126629	SODABAND PRO BG1 20/4-9	anthracite	4 mm	9 mm	20 mm	20/4-9	8	15	120
126632	SODABAND PRO BG1 20/5-12	anthracite	5 mm	12 mm	20 mm	20/5-12	5,6	15	84
121839	SODABAND PRO BG1 20/6-15	anthracite	6 mm	15 mm	20 mm	20/6-15	4,3	15	64,5
122845	SODABAND PRO BG1 20/9-20	anthracite	9 mm	20 mm	20 mm	20/9-20	3,3	15	49,5
126637	SODABAND PRO BG1 25/9-20	anthracite	9 mm	20 mm	25 mm	25/9-20	3,3	12	39,6
124794	SODABAND PRO BG1 25/11-25	anthracite	11 mm	25 mm	25 mm	25/11-25	2,6	12	31,2
126672	SODABAND PRO BG1 30/1-4	anthracite	1 mm	4 mm	30 mm	30/1-4	13	10	130
126656	SODABAND PRO BG1 30/2-6	anthracite	2 mm	6 mm	30 mm	30/2-6	12	10	120
123455	SODABAND PRO BG1 30/4-9	anthracite	4 mm	9 mm	30 mm	30/4-9	8	10	80
126636	SODABAND PRO BG1 30/5-12	anthracite	5 mm	12 mm	30 mm	30/5-12	5,6	10	56
126660	SODABAND PRO BG1 30/6-15	anthracite	6 mm	15 mm	30 mm	30/6-15	4,3	10	43
126638	SODABAND PRO BG1 30/9-20	anthracite	9 mm	20 mm	30 mm	30/9-20	3,3	10	33
126668	SODABAND PRO BG1 30/18-34	anthracite	18 mm	34 mm	30 mm	30/18-34	3,3	10	33
124793	SODABAND PRO BG1 35/18-34	anthracite	18 mm	34 mm	35 mm	35/18-34	3,3	8	26,4
126670	SODABAND PRO BG1 35/24-42	anthracite	24 mm	42 mm	35 mm	35/24-42	2,6	8	20,8
126666	SODABAND PRO BG1 40/5-12	anthracite	5 mm	12 mm	40 mm	40/5-12	5,6	7	39,2
126664	SODABAND PRO BG1 40/9-20	anthracite	9 mm	20 mm	40 mm	40/9-20	3,3	7	23,1
124795	SODABAND PRO BG1 40/24-42	anthracite	24 mm	42 mm	40 mm	40/24-42	2,6	7	18,2

Art. nr.	Description	Colour	Min. joint width	Max. joint width INSULATION	Max. joint width BACKFILLING	Tape width = joint depth	Meter/roll	Rolls/box	Meter/box
126612	SODABAND ACRYL 300 10/2	anthracite	2 mm	3 mm	8 mm	10 mm	12,5	30	375
126614	SODABAND ACRYL 300 15/2	anthracite	2 mm	3 mm	8 mm	15 mm	12,5	20	250
126711	SODABAND ACRYL 300 20/2	anthracite	2 mm	3 mm	8 mm	20 mm	12,5	15	187,5
126613	SODABAND ACRYL 300 10/3	anthracite	3 mm	5 mm	12 mm	10 mm	10	30	300
126615	SODABAND ACRYL 300 15/3	anthracite	3 mm	5 mm	12 mm	15 mm	10	20	200
126710	SODABAND ACRYL 300 20/3	anthracite	3 mm	5 mm	12 mm	20 mm	10	15	150
126618	SODABAND ACRYL 300 10/4	anthracite	4 mm	7 mm	16 mm	10 mm	8	30	240
126616	SODABAND ACRYL 300 15/4	anthracite	4 mm	7 mm	16 mm	15 mm	8	20	160
126617	SODABAND ACRYL 300 20/4	anthracite	4 mm	7 mm	16 mm	20 mm	8	15	120
126611	SODABAND ACRYL 300 15/6	anthracite	6 mm	10 mm	24 mm	15 mm	5,6	20	112
126712	SODABAND ACRYL 300 20/6	anthracite	6 mm	10 mm	24 mm	20 mm	5,6	15	84
126716	SODABAND ACRYL 300 30/6	anthracite	6 mm	10 mm	24 mm	30 mm	5,6	10	56
126715	SODABAND ACRYL 300 20/8	anthracite	8 mm	13 mm	32 mm	20 mm	4,3	15	64,5
152794	SODABAND ACRYL 300 30/8	anthracite	8 mm	13 mm	32 mm	30 mm	4,3	10	43

# MEMBRANES

Window tapes have already been used for airtight sealing around windows and doors for years. The Soudal range consists of different versions: for internal or external use, with butyl strip or full surface acrylic adhesive. The latest generation are smart window tapes which have a variable Sd value so they can be used both on the inside and outside.



## SWS VARIO EXTRA

Intelligent air- and watertight membrane with a variable Sd value

### DESCRIPTION:

SWS Vario Extra is a moisture-controlling membrane with a 2 or 3-part split liner for the air- and watertight sealing of joints around windows, doors and panels. With its special properties the Sd value adapts to seasonal variations in temperature and air humidity. This enables the weather-independent transport of moisture from inside to outside or vice versa for an optimal drying effect of the joint the whole year round.

**IN** **OUT**

### PROPERTIES:

- Air- and watertight (not suitable for primary water sealing)
- Variable Sd value: 0,03 – 15 m
- Moisture regulating
- Pressure-sensitive, self-adhesive strip on one side for adhesion to the window frame and full surface adhering on the other side for adhesion to the building structure
- Limited UV resistant, approx. 6 months
- Suitable for plastering and pasting over



## SWS INSIDE EXTRA

Air- and vapour tight window tape

### DESCRIPTION:

SWS Inside Extra window tapes are flexible membranes, which allow for an air- and vapour tight sealing of interior connections around windows, doors and panels. On top of the high quality self-adhesive strip on the print side, for adhesion to the window frame, the SWS Inside Extra is also equipped with a full-surface self-adhesive back side. So no additional adhesive is required.

**IN**

### PROPERTIES:

- Vapour barrier: Sd > 47 m
- Airtight
- Flexible and tear resistant
- Pressure sensitive self-adhesive strip for adhesion to the window frame
- Pressure sensitive full-surface self-adhesive back side for adhesion to the wall with 2- or 3-way split liner
- For indoor applications
- Can be plastered and bonded on



## SWS OUTSIDE EXTRA

Air- and driving rain tight and vapour open window tape

### DESCRIPTION:

SWS Outside Extra window tapes are flexible membranes, which allow for a vapour open, air-, driving rain sealing of exterior connections around windows, doors and panels. On top of the high quality self-adhesive strip on the print side, for adhesion to the window frame, the SWS Outside Extra is also equipped with a full-surface self-adhesive back side. So no additional adhesive is required.

**OUT**

### PROPERTIES:

- Vapour permeable: Sd ≤ 0,72 m
- Air- and driving rain and wind tight
- UV resistant
- Flexible and tear resistant
- Pressure sensitive self-adhesive strip for adhesion to the window frame
- Pressure sensitive full-surface self-adhesive back side for adhesion to the wall with 2- or 3-way split liner
- For outdoor applications
- Can be plastered and bonded on





# MEMBRANES

## SWS INSIDE STANDARD

Air- and vapour tight window tape



### DESCRIPTION:

SWS Inside Standard window tapes are flexible membranes, which allow for an air- and vapour tight sealing of interior connections around windows, doors and panels. The SWS Inside Standard is equipped with an high quality self-adhesive strip and release liner on the print side for adhesion to the window frame. To permanently bond the SWS Inside Standard window tape to the wall, always use Soudafoil 330D or 360H.

### PROPERTIES:

- Vapour barrier:  $S_d > 47 \text{ m}$
- Airtight
- Flexible and tear resistant
- Pressure sensitive self-adhesive strip for adhesion to the window frame
- For indoor applications
- Can be plastered and bonded on

IN

## SWS OUTSIDE STANDARD

Air- and driving rain tight and vapour open window tape



### DESCRIPTION:

SWS Outside Standard window tapes are flexible membranes, which allow for a vapour open, air-, driving rain sealing of exterior connections around windows, doors and panels. The SWS Outside Standard is equipped with an high quality self-adhesive strip and release liner on the print side for adhesion to the window frame. To permanently bond the SWS Outside Standard window tape to the wall, always use Soudafoil 360H.

### PROPERTIES:

- Vapour permeable: Standard:  $S_d \leq 0,06 \text{ m}$
- Air- and driving rain and wind tight
- UV resistant
- Flexible and tear resistant
- Pressure sensitive self-adhesive strip for adhesion to the window frame
- For outdoor applications
- Can be plastered and bonded on

OUT



## SODAFOIL 360H

Elastic sealant and adhesive for bonding all SWS window tapes



### DESCRIPTION:

Airtight, elastic, hybrid polymer based sealant and adhesive for full surface bonding of SWS Inside and SWS Outside Tapes to the building envelope. Does not contain isocyanates or solvents. Soudafoil 360H complies with DIN 4108-7 and is part of the Soudal Window System.

### PROPERTIES:

- Easy to tool, extrude (even at low temperatures) and finish in all weather conditions
- For interior and exterior use
- Stays elastic after curing and very sustainable
- UV resistant, waterproof and resistant to weathering
- Very high adhesive strength (without primer) on most common building materials even on damp surfaces

IN

OUT

## SODAFOIL 330D

Plasto-elastic sealant and adhesive for bonding SWS Inside window tapes



### DESCRIPTION:

Airtight plasto-elastic sealant and adhesive based on acrylic dispersion for bonding SWS Inside tapes. Only for interior use. Soudafoil 330D complies with DIN 4108-7.

### PROPERTIES:

- Easy to tool
- For interior and use only
- Low water vapour permeability
- Colour stable and waterproof after curing
- Very good adhesion on many porous materials and aluminium
- Free of solvents and silicones

IN

# MEMBRANES

CE

## EPDM MEMBRANE

Air- and watertight EPDM based façade membrane

### DESCRIPTION:

Soudal EPDM Membrane is a very tear-resistant, elastic and bitumen compatible air-and watertight membrane made of EPDM rubber

### PROPERTIES:

- Air- and watertight
- Compatible with bitumen
- Good temperature resistance
- Good weather and UV resistance
- Resistant against alkali micro-organisms
- Stays elastic
- Flexible
- High tear resistance
- Complies with EN13984

IN OUT



CE

## EPDM MEMBRANE FIX

EPDM membrane fix

### DESCRIPTION:

Soudal EPDM Membrane Fix is a very tear-resistant, elastic and bitumen compatible air-and watertight membrane made of EPDM rubber. Soudal EPDM Membrane Fix contains a self-adhesive butyl strip for direct adhesion to the facade element.

### PROPERTIES:

- Air- and watertight
- Adhesive strip (= time-saving mounting)
- Compatible with bitumen
- Good temperature resistance
- Good weather and UV resistance
- Resistant against alkali
- Stays elastic
- Flexible
- High tear resistance
- Complies with EN13984

IN OUT



atg CE

## SILIRUB EPDM

CE-marked sealant compatible for all Soudal EPDM membranes

### DESCRIPTION:

Silirub EPDM is a high-quality, neutral, elastic one-component joint sealant based on fast skinning silicones.

### PROPERTIES:

- Very easy to apply
- Colourfast and UV resistant
- Permanently elastic after curing
- Very good adhesion on many materials
- Low modulus
- Especially developed for EPDM applications
- MEKO free

IN OUT



ECTI CE

## SODASEAL EPDM

Adhesive compatible for all Soudal EPDM membranes

### DESCRIPTION:

Soudaseal EPDM is a high quality, neutral, elastic, 1-component Hybrid polymer based adhesive sealant for bonding and sealing of Soudal EPDM membranes in interior and exterior applications.

### PROPERTIES:

- Very good adhesion to Soudal EPDM membranes
- Good adhesion on most common building materials.
- Primerless adhesion even on damp surfaces due to unique adhesion promoters.
- Easy to tool, extrude (even at low temperatures) and finish in all weather conditions.
- Stays elastic after curing and very durable
- Solvent, halogen, acid and isocyanate free
- UV resistant, waterproof and resistant to weathering

IN OUT





# SEALANTS

Joints can have different purposes. Elastic sealants are an important part of the building envelope where the different parts move separately in relation to each other. As a leading expert in sealants, Soudal can always offer the right product for each specific application. All our products always satisfy the most stringent standards, so you can rely on the quality of our sealants for years on end.



## SODASEAL 215 LM

Neutral cure, elastic MS-Polymer® based joint sealant



### DESCRIPTION:

ATG approved facade sealant based on MS polymer®. This high quality sealant has a large movement capability (class F-EXT-INT-CC- 25LM in accordance with the new CE marking). Particularly suitable as a long-term sealant for expansion joints exposed to all weather conditions. Ideal for sealing joints between exterior joinery and the outer cavity wall leaf, even for natural stone (threshold).

### PROPERTIES :

- Permanently elastic after curing
- Tested to and in accordance with ISO 11600 F-25LM
- Easy to tool, extrude (even at low temperatures) and finish in all weather conditions
- Good weather and UV resistance
- Broad bonding spectrum on porous and non-porous materials, even on slightly wet substrates
- No staining effect on natural stone

**IN** **OUT**



## SILIRUB PRO N

Premium neutral cure, elastic silicone based joint sealant



### DESCRIPTION:

For the professional sealing of expansion and connection joints with extreme continuous load throughout the construction sector, such as outdoor vapour open connection joints between masonry and windows and doors according to EnEV DIN 4108 and RAL installation guidelines. Complies with DIN 18545 Part 2, E / ISO 11600-F-25LM.

### PROPERTIES:

- Permanently elastic after curing
- UV resistant
- Long open time
- Excellent moisture and mold resistance
- Very good adhesion on many materials

**IN** **OUT**



## ACRYRUB SWS

Elastic silanised acrylic joint sealant conform DIN EN ISO 116000 F 12,5 E



### DESCRIPTION:

Plastering up to the window frame will cause small tears and debonding after only a short time, which will have a negative impact on the airtightness. To avoid this, it is best to use a paintable sealant with sufficient movement capability. Acryrub SWS was developed especially for this application, about the only acrylic sealant meeting the class 12,5 E requirements (CE marking F-EXT-INT-12.5E).

### PROPERTIES:

- Airtight
- Permanently elastic after curing
- Colour stable and waterproof
- Very good adhesion on many porous substrates, hard PVC and aluminium
- Can be painted over after curing

**IN**

# SEALANTS



## SILIRUB WS

Neutral cure, elastic silicone for dilatation joints in curtain walls

### DESCRIPTION:

Silirub WS is a high-quality, neutral, elasticone-component joint sealant based on fast skinning silicones. Silirub WS has been developed for weather sealing of expansion joints in the façade industry.

### PROPERTIES:

- Compatible with PVB-film
- Compatible with sealants for double glazing
- Permanently elastic after curing
- Neutral curing
- Resistant against UV-radiation, rain, frost, wind, ozone and extreme temperatures
- Excellent adhesion properties on glass (laminated), coated aluminium, galvanised steel, concrete and masonry
- Very good resistance to ageing
- Not suitable for natural stone
- MEKO free



## FIX ALL HIGH TACK

The perfect sealant and adhesive to seal and bond in all conditions

### DESCRIPTION:

Fix ALL High Tack is a high quality, neutral, elastic, 1-component adhesive sealant based on SMX-Polymer with a very high initial tack. Fix ALL High Tack is a KO-MO-certified construction adhesive based on BRL3107.

### PROPERTIES:

- High initial tack reducing the need for initial support
- Fast curing
- High shear strength after full cure (no primer)
- Stays elastic after curing and very durable
- Impervious to mould
- Can be painted with water based systems
- Good weather and UV resistance
- Does not contain isocyanates and no silicones
- Good adhesion on slightly moist substrates



## SILIRUB 2

Top-grade, neutral cure silicone for a wide range of applications

### DESCRIPTION:

ATG approved for use in facade and glazing joints. Very large movement capability (class F-EXT-INT-CC-25LM and G-CC-25LM in accordance with the new CE marking - harmonised standard EN15651 or 25 F/G in accordance with the EN ISO11600 standard). Ideal as a sealant between exterior joinery and the exterior cavity wall leaf (not suitable for natural stone) or for glazing applications. Available in many colours.

### PROPERTIES:

- Permanently elastic after curing
- Test and in accordance with ISO 11600 F&G 25 LM
- 100% silicone, no shrinkage
- Colour stable and UV resistant
- Very good adhesion on many materials



## SILIRUB COLOR

Top-grade, neutral cure silicone based sealant using the RAL® colour system

### DESCRIPTION:

Neutral silicone sealant, of high quality. Bonds on most building substrates. Permanent elasticity unalterable colour and resistant to UV radiation. Available in the most common colours used for windows.

### PROPERTIES:

- Available in all RAL Classic System colours
- Permanently elastic after curing
- Conforms to ISO 11600 F&G 25 LM
- 100% silicone, no shrinkage
- Colour stable and UV resistant
- Very good adhesion on many materials



# VAPOUR BARRIERS

As a specialised adhesive manufacturer, Soudal has developed a special airtight sealants and adhesives for the airtight bonding of all types of vapour barriers to the inside of the brickwork. It can also be used to glue wood derivatives in timber frame constructions. To seal overlaps of vapour barriers and penetrations, adhesive tapes are often used. Soudatapes adheres to most surfaces, including PE and PP. They are perfectly suited for timber frame construction.



## VAPOURSEAL

Air- and vapour tight plasto-elastic adhesive for bonding of all types of vapour barriers

### DESCRIPTION:

Adheres to all types of vapour barrier foils, even those made from PP and PE. Ideal for bonding a vapour tight layer to a mineral surface: brick, concrete, pre-fab materials. Vapourseal is also particularly suitable for the airtight sealing of wood derivatives in timber framed houses, such as bonding multiplex encasings for exterior joinery.

### PROPERTIES:

- Air- and vapour tight
- Excellent adhesion onto all types of vapour barriers
- Good adhesion on slightly moist substrates
- Permanent flexibility
- Good sag resistance
- UV resistant

IN



# VAPOUR BARRIERS

## SOUDATAPE CONNECT

Permanent airtight self-adhesive tape



### DESCRIPTION:

Adhesive tape for long-term airtight bonding of vapour barrier overlaps on the inside. Also ideal for repairing small holes and tears in vapour control layers and for an easy and quick airtight seal of butt-joints between wood-based panels (e.g. OSB).

IN

### PROPERTIES:

- Splash-resistant paper carrier
- Vapour permeable Sd 0,3-2 m
- Moisture resistant
- Can be torn by hand
- Solvent free powerful adhesive layer
- Superior adhesion to most common foils, non-woven materials, wood, aluminium and PVC
- Good temperature resistance
- For internal use only

## SOUDATAPE FLEX

Flexible airtight self-adhesive tape



### DESCRIPTION:

Elastic adhesive tape for permanent airtight bonding of overlaps of and penetrations (pipes, ducts, beams) through the vapour barrier.

IN

### PROPERTIES:

- Carrier made from strengthened PE
- Vapour tight: Sd value 20-30 m
- High tear-resistance
- Solvent free, powerful reinforced adhesive layer with very good resistance to ageing
- Superior adhesion to the most common foils, non-woven materials, wood, aluminium and PVC
- Good temperature resistance
- For internal use only

## SOUDATAPE FAÇADE

Airtight adhesive tape for general in- and outdoor use



### DESCRIPTION:

Adhesive tape for general airtightness on the inside and outside of the building envelope. Particularly suitable for airtight bonding of butt-joints between wood-based panels (e.g. OSB) and the joints with neighbouring materials, such as skylights. Can also be used on black damp-proof sheets behind ventilated facade cladding.

IN OUT

### PROPERTIES:

- Carrier made from special PP fleece
- Vapour permeable Sd 0,3-2 m
- Moisture resistant
- High tack solvent free adhesive layer with very good resistance to ageing
- Superior adhesion to the most common foils, non-woven materials, wood, aluminium and PVC
- Good temperature resistance
- Three months of weather- and UV resistance
- For internal and external use

# ACCESSORIES

To facilitate the application of SWS products during the installation of windows and doors until cleaning, Soudal offers a range of accessories selected by our experts. The right tools is half the job!



## GUN & FOAM CLEANER

Cleaning aerosol for uncured PU foams

### DESCRIPTION:

To remove residual polyurethane foam that has not yet cured on all non-porous surfaces. Ideal for cleaning the inside and outside of guns and other tools. Filled with harmless HCFC- and CFC-free propellants.



## PU-REMOVER

Cleaning kit for cured PU foam

### DESCRIPTION:

Fast and highly effective remover for hardened PU foam residues on all non-porous surfaces.



## SILICONE REMOVER

Ready-to-use and fast-working

### DESCRIPTION:

Silicone Remover is a ready-to-use and fast-working product based on hydrocarbons for removing hardened silicones and MS polymers.



## SWIPEX

Extra big size cleaning wipes

### DESCRIPTION:

Dissolves fresh and uncured adhesive and sealant remains (silicone, hybrid polymer, PU, acryl...) as well as PU-foam, paint etc on all non-porous substrates. Can also be used to clean uncured remains and dirt from hands and tools, dermatologically safe to use.





### DESIGN FOAM GUN

Heavy duty metal PU foam applicator.

#### DESCRIPTION:

The Soudal Design Foam Gun is a professional, heavy duty, metal foam applicator tool with precise, adjustable dosing properties. Available with standard screw connection or Click&Fix.



### COMPACT FOAM GUN

Lightweight, compact foam applicator

#### DESCRIPTION:

The Soudal Compact Foam Gun is an high quality, easy to clean, lightweight foam applicator tool with precise, adjustable dosing properties. Available with standard screw connection or Click&Fix.



### PROFESSIONAL CAULKING GUN

Heavy duty skeleton cartridge gun

#### DESCRIPTION:

Professional grade, metal skeleton caulking gun for standard cartridges up to 310 ml. High performance, strong and durable. The cartridge dispenser is features an high trust ratio for a smooth extrusion, even for high viscous products, and a dripless system, to prevent excess caulk leakage.



### FOILPACK CAULKING GUN

Top-grade manual caulking gun for foil packs up to 600 ml

#### DESCRIPTION:

Its durable design is perfect for frequent high volume use and features an easy to clean aluminum barrel. This caulking gun also features an instant pressure release tab, to prevent excess caulk leakage.

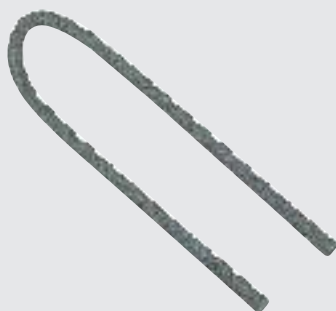

### PE-PU BACKER ROD

Ready-to-use and fast-working

#### DESCRIPTION:

Soudal backer rods are round in profile and made from closed-cell PE or open-cell PU foam. The backer rods are used as non-adhesive back-filling in construction joints and to ensure correct joint dimensions for sealants. Supplied in 1 m lengths.



### WINBAG

Air Wedge levelling tool

#### DESCRIPTION:

Powerful hand operated inflatable air cushion for levelling and fixing. Load-bearing capacity 135 kg per Winbag. Joint width 2-50 mm. Fibre reinforced material. With the WINBAG, a single professional installer can position, adjust, align, level and hold work materials in place, saving time and reducing costs.

# PRODUCTS

## FOAMS

Art. nr.	Description
117472	750mL FLEXIFOAM GUN
118318	750mL FLEXIFOAM CLICK & FIX

## LIQUID MEMBRANES

Art. nr.	Description
145785	4,5 KG SOUDATIGHT LQ BLACK
145788	4,5 KG SOUDATIGHT LQ WHITE
146281	600 ML SOUDATIGHT LQ WHITE
154260	600 ML SOUDATIGHT LQ BLACK
130715	1 KG SOUDATIGHT SP Gun Black
131610	1 KG SOUDATIGHT SP Gun White
145787	11 KG SOUDATIGHT SP BLACK
145789	11 KG SOUDATIGHT SP WHITE
134739	16 KG SOUDATIGHT SP BLACK
130545	600 ML SOUDATIGHT HYBRID GREY
145786	6 KG SOUDATIGHT HYBRID GREY
131003	SOUDATEXILE 15 CM X 20 M
130872	SOUDATIGHT GUN
131296	NOZZLE SOUDATIGHT SP GUN (5 PCS)
131896	10 sets of nozzles for Cox Jetflow
131824	Cox Jetflow 3 Foil bag

## MEMBRANES

Art. nr.	Description
145962	SWS Inside Standard 70 mm
145961	SWS Inside Standard 100 mm
145963	SWS Inside Standard 150 mm
153508	SWS Inside Standard 200 mm
153507	SWS Inside Standard 250 mm
153506	SWS Inside Standard 300 mm
145960	SWS Outside Standard 70 mm
145965	SWS Outside Standard 100 mm
145959	SWS Outside Standard 150 mm
153505	SWS Outside Standard 200 mm
153504	SWS Outside Standard 250 mm
153503	SWS Outside Standard 300 mm
145964	SWS Inside Extra 70 mm
145958	SWS Inside Extra 100 mm
145967	SWS Inside Extra 150 mm
145957	SWS Outside Extra 70 mm
145966	SWS Outside Extra 100 mm
145968	SWS Outside Extra 150 mm
132559	SWS Vario Extra 70 mm
132557	SWS Vario Extra 100 mm
132558	SWS Vario Extra 140 mm
135315	SWS Vario Extra 200 mm
137382	SWS Vario Extra 290 mm
146705	SWS Vario Extra 400 mm
120157	600 ML SOUDAFOIL 360H
120158	600 ML SOUDAFOIL 330 D
130283	SOUDAL EPDM MEMBRANE FIX 0,8X150MM/20M
130284	SOUDAL EPDM MEMBRANE FIX 0,8X200MM/20M
130285	SOUDAL EPDM MEMBRANE FIX 0,8X250MM/20M
130286	SOUDAL EPDM MEMBRANE FIX 0,8X300MM/20M
130287	SOUDAL EPDM MEMBRANE 1,2X200MM/20M
130288	SOUDAL EPDM MEMBRANE 1,2X250MM/20M
130289	SOUDAL EPDM MEMBRANE 1,2X300MM/20M

## SEALANTS

Art. nr.	Description
112501	300 ML SILIRUB EPDM
112130	600 ML SILIRUB EPDM
130549	600 ML SOUDASEAL EPDM
	SOUDAEAL 215LM
	SILIRUB PRO N
	ACRYRUB SWS
	SILIRUB WS
	FIX ALL HIGH TACK
	SILIRUB 2
	SILIRUB COLOR

## VAPOUR BARRIERS

Art. nr.	Description
122391	310 ML VAPOURSEAL
123020	600 ML VAPOURSEAL
125013	SOUDATAPE CONNECT 60MM X 40M
125014	SOUDATAPE FLEX 60MM X 25M
128401	SOUDATAPE FLEX 125MM X 25M
125012	SOUDATAPE FACADE

## ACCESSORIES

Art. nr.	Description
123001	GUN & FOAM CLEANER
115778	PU-REMOVER
102853	SILICONE REMOVER
128470	SWIPEX CLEANING WIPES (50 PCS)
103266	DESIGN SOUDAL FOAM GUN
106016	DESIGN SOUDAL FOAM GUN CLICK&FIX
109953	SOUDAL COMPACT FOAM GUN
110226	SOUDAL COMPACT FOAM GUN CLICK&FIX
106617	PROFESSIONAL CARTRIDGE CAULKING GUN
106515	PROFESSIONAL FOIL PACK CAULKING GUN
110307	6MM PE BACKER ROD GREY
110308	10MM PE BACKER ROD GREY
110309	13MM PE BACKER ROD GREY
110310	15MM PE BACKER ROD GREY
106783	20MM PE BACKER ROD GREY
110422	25MM PE BACKER ROD GREY
110423	30MM PE BACKER ROD GREY
110283	15MM PU BACKER ROD BLACK
110284	20MM PU BACKER ROD BLACK
110285	25MM PU BACKER ROD BLACK
110286	30MM PU BACKER ROD BLACK
110287	40MM PU BACKER ROD BLACK
110288	50MM PU BACKER ROD BLACK
124490	SOUDAL WINBAG SET (4 PCS)



**SODAL NV**  
**EVERDONGENLAAN 18-20**  
**B-2300 TURNHOUT**  
**TEL.: +32 (0)14 42 42 31**  
**FAX: +32 (0)14 42 65 14**  
**EMAIL: SALES@SODAL.COM**  
**WWW.SODAL.COM**

**YOUR DISTRIBUTOR**

